



HEINZ

PRODUCT SPECIFICATION SHEET

PRODUCT: CHEF FRANCISCO CHEESEBURGER CHOWDER

VARIETY NUMBER: 687040 - 78001429

PACKAGE SIZE: 4 – 8 LB BAGS PER CASE

PRODUCT DESCRIPTION: A unique soup with a hearty cheese flavor, featuring ground beef, shredded potatoes and onions.

READY TO COOK

PREPARATION INSTRUCTIONS:

Boil-in-Bag:

1. CAREFULLY PLACE UNOPENED BAG OF PRODUCT IN BOILING WATER.
2. COOK UNTIL CONTENTS REACH 185°F.
3. CHECK TEMPERATURE BY REMOVING BAG FROM WATER; FOLD THE UNOPENED BAG AROUND A STEMMED THERMOMETER.
4. TRANSFER COOKED PRODUCT TO HOLDING OR SERVING CONTAINER:
 - a. FOR EASIER HANDLING, INSERT POUCH INTO LARGE PITCHER.
 - b. CUT OPEN CORNER OF POUCH OPPOSITE PITCHER HANDLE.
5. CAREFULLY POUR INTO SERVING CONTAINER; HOLD & SERVE AT GREATER THAN 150°F.

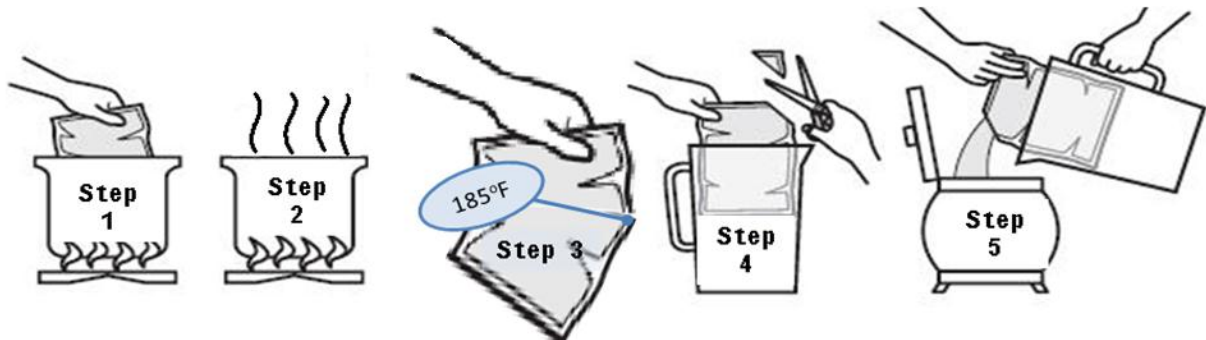

FOLLOW THE FDA FOOD CODE FOR HANDLING LEFTOVERS.

ANALYTICAL DATA: Available Upon Request

MICROBIOLOGICAL DATA: Available Upon Request



CONTAINER PACKAGING:

Container: 8 lb Bag

CONTAINER CODING: Primary Packaging

PP YM DD BBBB TT:TT (Explanation below)

CASE PACKAGING:

Pack/Size: 4/8 lb
Case Net Wt: 32
Case Gross Wt: 33.00 lbs
Case Cube: 0.74
Case Size (OD): 14.438" x 8.625" x 10.25"
Cases/Pallet: 65
Cases/Layer: 13
Layers/Pallet: 5

CASE CODING: Secondary Packaging

Example: PP YM DD TT:TT (Explanation Below)

CODE DESIGNATION

Each case and unit is labeled with a code designation which includes plant location, date of production, batch number and production line.

PPYMDD TT:TT

- P - Plant code** - LD = Cedar Rapids
- Y - Year** - 1 digit (last digit of year)
- M - Month** - 1 alpha (see month code key below)
- D - Day of Month** - 2 digits
- B - Batch Identifier** - 3 digits and 1 alpha
- T - Military Time** - 4 digits w/ colon

Example: For product packed at Cedar Rapids on 07/27/2013 at 2:30 PM would read:

LD 3G27 14:30

Month Code Key (Note: the letter "I" is not used)

- A = January
- B = February
- C = March
- D = April
- E = May
- F = June
- G = July
- H = August
- J = September
- K = October
- L = November
- M = December

MANUFACTURING LOCATION: CEDAR RAPIDS, IOWA, P15818A, M15818A

STORAGE: Keep frozen at or below 0°F

DISTRIBUTION: Keep frozen

SHELF LIFE: 730 days



INGREDIENT STATEMENT: CHICKEN BROTH, MILK (VITAMIN D3), PASTEURIZED PROCESS CHEESE SPREAD (AMERICAN CHEESE [CULTURED MILK, SALT, ENZYMES], WATER, WHEY, SODIUM PHOSPHATE, WHEY PROTEIN CONCENTRATE, SKIM MILK, SALT, MILKFAT, ARTIFICIAL COLOR), COOKED HAMBURGER CRUMBLES (BEEF, SALT), SHREDDED HASHBROWN POTATOES (POTATOES, DEXTROSE, DISODIUM DIHYDROGEN PYROPHOSPHATE), ONIONS, ENRICHED FLOUR (BLEACHED WHEAT FLOUR, MALTED BARLEY FLOUR, NIACIN, IRON, THIAMIN MONONITRATE, RIBOFLAVIN, FOLIC ACID), RENDERED BEEF FAT (BEEF FAT, BHT, CITRIC ACID), MODIFIED CORN STARCH, SALT, CHICKEN FAT, CHEESE FLAVOR (ENZYME MODIFIED CHEDDAR CHEESE AND BUTTER [CHEDDAR CHEESE (MILK, CHEESE CULTURE, SALT, ENZYMES), BUTTER, CHEESE CULTURE, ENZYMES], WHEY, BUTTERMILK SOLIDS, SALT, SODIUM PHOSPHATE, LACTIC ACID, YELLOW 5, YELLOW 6), POTASSIUM CHLORIDE, SUGAR, NATURAL FLAVOR, NATURAL SALT ENHANCER (POTASSIUM CHLORIDE, CORN MALTODEXTRIN, YEAST EXTRACT, SALT, VINEGAR SOLIDS, NATURAL FLAVORS), SPICES, WHEY POWDER, ONION POWDER, GRILL FLAVOR (CANOLA OIL, SUNFLOWER OIL, NATURAL FLAVORS), ANNATTO EXTRACT (COLOR).

ALLERGENS: MILK, WHEAT

NUTRITIONAL DATA:

Per Serving

Nutrition Facts	
Serving Size 1 cup (245g)	
Servings Per Container 59	
Amount Per Serving	
Calories 270	Calories from Fat 150
% Daily Value*	
Total Fat 17g	26%
Saturated Fat 9g	45%
Trans Fat 0.5g	
Cholesterol 45mg	15%
Sodium 920mg	38%
Total Carbohydrate 17g	6%
Dietary Fiber 1g	4%
Sugars 5g	
Protein 13g	
Vitamin A 10%	• Vitamin C 2%
Calcium 20%	• Iron 4%
*Percent Daily Values are based on a 2,000 calorie diet. Your daily values may be higher or lower depending on your calorie needs:	
	Calories: 2,000 2,500
Total Fat	Less than 65g 80g
Saturated Fat	Less than 20g 25g
Cholesterol	Less than 300mg 300 mg
Sodium	Less than 2,400mg 2,400mg
Total Carbohydrate	300g 375g
Dietary Fiber	25g 30g
Calories per gram:	
Fat 9 • Carbohydrate 4 • Protein 4	